

Hollow Metal Doors

FIRE RATED

SPECIFICATIONS

Door	18 GA. Cold-rolled Steel
Paint	Prime painted
Hinge Prep	Non-handed 4-1/2" 10 GA. Can accommodate heavyweight hinges
Construction	Laser-Welded Edge Seam
Channels	16 GA. Inverted Top and Bottom
Insulation	Polystyrene Core
Top Cap	18 GA. Flush
Edges	Square hinge and lock edges
Closer Reinforcement	14 GA. Cold-rolled Steel

OPTIONS

Door Types	Flush; 6 Panel
Insulation	Honeycomb (Special Order)
Lock Preps	161, 86 edge and RIM / SVR
Galvanized Steel	ASTM A653 / A653M-A60

CERTIFICATIONS

**3 Hour Intertek / Warnock Hersey, UBC 7-2 (1997):
ASTM E2074 (200): UL 10(b) (2008): NFPA 252 (2008):
UL 10(b) Revision 1 (2009): UL 10(c) (2009):
CAN / ULC S104 (2010):
Built to SDI Specifications ANSI A250.8**





Hollow Metal Doors

FIRE RATED

Door Dimensions

3068 Door

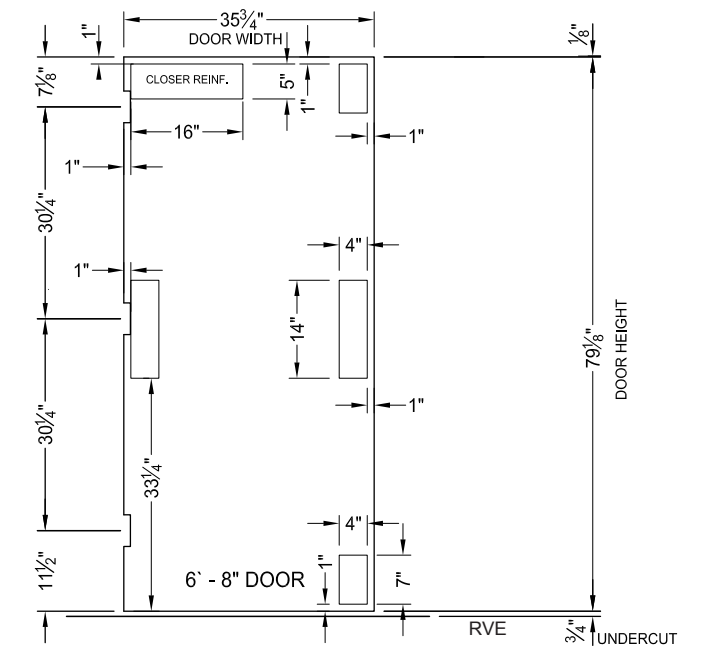
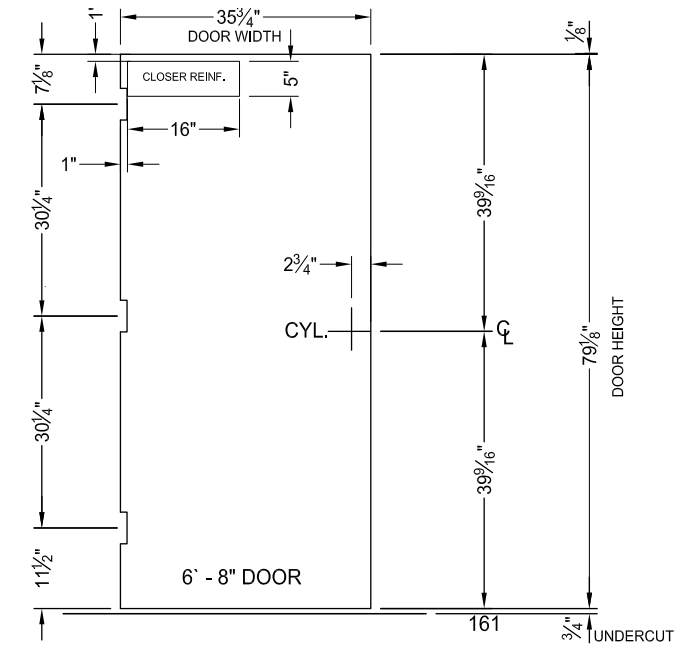

3070 Door

